

Service Instructions

Syntron® Jogger
Model: J-1-B



Service Instructions

Syntron® Jogger

Model: J-I-B

Contents	Page
Introduction	1
Installation	2
Operation	2
Maintenance	2
Trouble Shooting	3
Parts List	4
Illustration	4



Syntron Material Handling, LLC. reserves the right to make changes at any time, without notice and without any liability or other obligation on its part, in materials, equipment, specifications and models, and also to discontinue the manufacture and sale of models and the parts and components thereof. For further detailed information, contact Syntron Material Handling, LLC.

! Safety Instructions: Product safety labels must be highly visible on the equipment. Establish a regular schedule to check visibility. Should safety labels require replacement, contact Syntron Material Handling, LLC. for an additional supply free of charge.

INTRODUCTION

The Syntron® Electromagnetic Jogger, Model J-I-B is used for jogging and packing of materials. A magnet assembly produces a vibrating action, which is transmitted to the deck or rack through a system of leaf springs.

The control assembly consists of an ON/OFF switch, a rheostat to control the amplitude of vibration and a rectifier to convert AC to DC.

Refer to these service instructions prior to installing, adjusting, or performing maintenance on this jogger.

! WARNING: Failure to follow these instructions could result in unsatisfactory jogger performance, damage or shortened service life, or personal injury.

Inspect the jogger for damage which may have occurred during shipment. If any damage is found, immediately notify the shipping carrier and Syntron Material Handling, LLC..

Unauthorized modifications to the jogger may present a safety hazard to the operator and void the warranty. Modifications or additions to the jogger should not be made without first consulting Syntron

Material Handling, LLC. Application Specialist in Homer City, or your Syntron Material Handling, LLC. Regional Sales Engineer.

The jogger weighs approximately 25 pounds and must be lifted by the base only. The voltage and frequency of the power supply must be as specified on the nameplate. The power supply of another rating may cause damage to the unit.

INSTALLATION

 **CAUTION:** To prevent possible damage, lift the jogger by the base only. Lifting by the bin or top cover may cause damage.

Locate the jogger on a solid support. The support must not vibrate while the jogger is operating. The bin or top cover must not be in contact with any rigid object or adjacent surface; it must be free to vibrate.

OPERATION

Place the jogger in its operating location and plug it into a self-grounding electrical receptacle. The power supply voltage and frequency must be as specified on the nameplate.

The vibratory amplitude of the unit is changed by a rheostat located on the control. Various deck configurations are available. See Syntron Material Handling, LLC. Syntron product literature for further details, capacities, etc.

For maximum efficiency, Syntron Material Handling, LLC. recommends a maximum load of 10 pounds for the J-1-B Jogger.

MAINTENANCE

Adjusting the Air Gap

 **WARNING:** The air gap must be adjusted while the jogger is in operation. Exercise caution to prevent electrical shock to personnel or damage to the jogger.

A striking condition (indicated by a loud rapping noise) is caused by "too close" of an air gap. An excessive current draw (indicated by excessive heat) is caused by "too wide" of an air gap.

 **Caution:** Do not operate the jogger when either condition exists. An adjustment of the air gap is required.

Place the jogger in a position to gain access to the adjustment screw on the bottom. As suggested in Figure 1, place the jogger between two tables. Supporting the jogger by the bin or cover, or hand-holding the jogger will affect the adjustment of the air gap. The unit must be supported at the rubber feet.

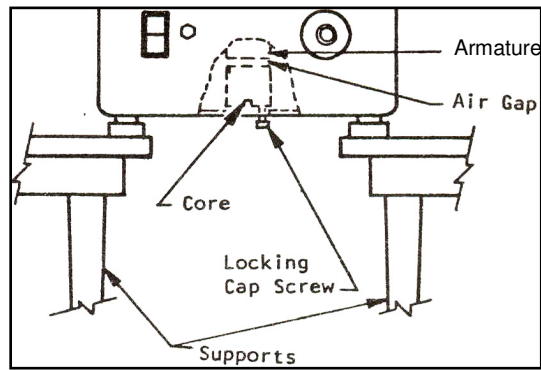

Fig. 1 - Air Gap Adjustment

Plug the electrical cord into a receptacle and operate the jogger at "100" dial setting. On the bottom of the jogger, loosen the socket head cap screw, which locks the core in position. Adjust the air gap using a screwdriver in the slot adjacent to the locking cap screw.

Note: Turning the screwdriver clockwise will lessen the air gap (to lessen the current draw). Turning the screwdriver counterclockwise will widen the air gap (increasing the current draw).

To adjust the air gap to a proper setting, turn the knob on the front of the jogger to a "100" dial setting. Then turn the core clockwise until a striking condition exists, then immediately turn the screwdriver counterclockwise, just until the striking stops.

Check the current draw of the jogger using an a-c ammeter. If a clamp-on type ammeter is used the reading must be multiplied by 1.7. Do not exceed a current draw of 1.0 amps.

When the proper air gap has been achieved (indicated by the current draw), lock the core in place by turning the socket head cap screw on the bottom of the jogger. The jogger is now ready for further operation.

TROUBLE SHOOTING

PROBLEM	CAUSE	CORRECTION
Unit does not operate	Defective rheostat Shorted wiring, loose connection, no power to unit	* Replace Repair
Unit operates, will not vibrate	Defective rectifier Defective leaf springs Unit In contact with rigid object or adjacent surface	*Replace *Replace Isolate unit
Excessive noise	Armature and magnet assemblies making contact	Adjust air gap

*Replace only with parts supplied, or recommended, by Syntron Material Handling, LLC.

PARTS LIST

<u>Item No.</u>	<u>Description</u>	<u>Qty.</u>	<u>Part No</u>
A	Top Cover (for 2-bin rack)	1	A-114794-A
B	Cover Support	1	A-114795
C	Hex Hd. Cap Screw (5/16"-18 x 1-1/8")	1	H0354524
D	Hex Hd. Cap Screw (5/16"-18 x 1")	1	H0354724
E	Spring Clamp	2	A-91816
F	Spacer (for single-bin rack)	1	A-91818-2
G	u Spacer	—	A-91817
H	Spacer (for single-bin rack)	3	A-91819-B
J	Spring (for single- and 2-bin racks)	2	A-91815-A1
K	Spring (for 7" x 10" flat deck only)	2	A-91815-C1
M	Spacer	2	A-97983-2
N	Coil Clamp Cap Screw (5/16" – 18 x 1/2")	4	H0306401
P	Coil Washer	2	A-81849
Q	Armature	1	A-91812
R	Core	1	A-91811
	Socket Head Cap Screw (#10-32 x 1/2")	1	H0430600
S	Coil (115V Units Only)	1	A-91805-A
	Coil (230V Units Only)	1	A-91805-B
T	Base	1	B-90992-A
U	Rheostat	1	0052X168
V	Base Cover	1	B-91807
	v Nameplate	1	A-62244
W	3/8" Ext. Shakeproof Lockwasher	1	H0113204
	Dial	1	A-87522-A
	Knob	1	0118X013
X	1/4" Shakeproof Lockwasher	4	H0112705
	Foot	4	0207X024
	Tube	4	0335X001
	Rd. Hd. Mach. Screw (1/4" – 20 x 3/4")	4	H0205101
Y	v Caution Label (Disc. Elec.)	1	A-125694
Z	v Instruction Label	1	A-195774
AA	Switch	1	0051X477
BB	Cable Assembly (115V Units Only)	1	A-99587-A
	(230V Units Only)	1	A-107362
CC	Rectifier Assembly (115V Units Only)	1	A-175582-B
	(230V Units Only)	1	A-175582-C
	Rd. Hd. Mach. Screw (#10 – 32 x 3/8")	1	H0203102
	λ #10 – 32 Acorn Nut	1	H0101028
	λ #10 Lockwasher	1	H0112305

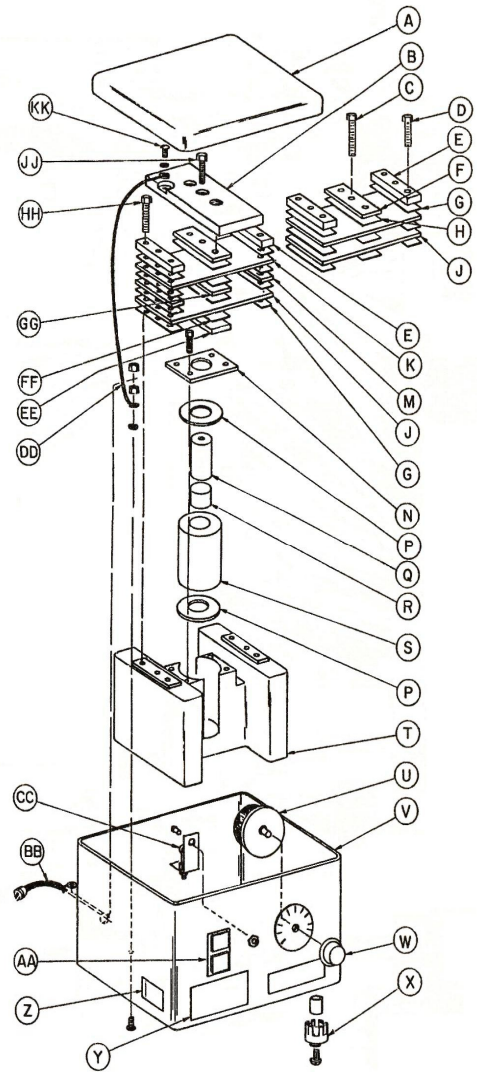

Current Rating:		
115V	50 / 60 Hz	1.0 Amp
230V	50 / 60 Hz	0.5 Amp

PARTS LIST

<u>Item No.</u>	<u>Description</u>	<u>Qty.</u>	<u>Part No</u>
DD	Brass Rd. Hd. Mach. Screw (#10 – 32 x 1/2")	1	H0203402
	#10 Lockwasher	1	H0112404
	Ground Strap assembly	1	A-164473-A
	#10 – 32 Hex Nut	2	H0101003
EE	Armature Plate	1	A-91813
FF	σ Spacer	4	A-91819
GG	σ Spacer	2	A-91818-2
HH	σ Hex Hd. Cap Screw (5/16" – 18 x 1-1/8")	8	H0354724
JJ	σ Hex Hd. Cap Screw (5/16" – 18 x 1-1/2")	1	H0354624
KK	Rd. Hd. Machine Screw (#10-32 x 3/8")	1	H0203102
	Lockwasher #10	1	H0112305

υ 8 required, 2 – Bin Rack and 7" x 10" Flat Deck
6 required, Single – Rack

σ Not used for Single – Bin Rack

λ Lockwasher must be used under Acorn Nut to insure proper ground

ν Do not remove or paint over safety labels. If safety labels need replaced, contact Syntron Material Handling, LLC., 57 Cooper Avenue, Homer City, PA 15748, (724) 479-4500, for an additional supply free of charge.

Important

Syntron Material Handling reserves the right to alter at any time, without notice and without liability or other obligations on its part, materials, equipment specifications, and models. Syntron Material Handling also reserves the right to discontinue the manufacture of models, parts, and components thereof.

Your satisfaction is very important to us. Please direct any comments, questions, or concerns to our Marketing Communications Department.

Syntron Material Handling

Corporate Office

P.O. Box 1370

Tupelo, Mississippi 38802

Phone: 662.869.5711

Fax: 662.869.7449

Syntron®
Link-Belt®

Tupelo

2730 Hwy 145 South
Saltillo, Mississippi 38866

Phone: 662.869.5711

Fax: 662.869.7493

Toll Free: 800.356.4898

info@syntronmh.com

Changshu

#2 Road No. 1

Changshu Export Processing Zone

Changshu, Jiangsu, China 215513

Phone: +86 0512.52299002

Fax: +86 0512.52297228

info@syntronmh.com